



# A511

## Auger Stabilizer Kit

### Portable Grain Auger

### Installation Instructions

This manual applies to:

AGI Westfield MKX<sup>2</sup> 13 (84/94/114)

AGI X<sup>2</sup> 13 (114)

## Pre-Installation Instructions

1. Park the auger on level ground. Fully lower the auger.
2. Relieve pressure in the hydraulic hose(s) and disconnect them from the tractor.
3. Chock the auger wheels to prevent rolling.
4. Lower the swing hopper fully to the ground.
5. Use the jack to support the boot, then disconnect the tractor from the auger (PTO shaft and hitch).
6. Disconnect the stabilizer braces from the short crossmember.
7. Remove the short crossmember from the lower frame.

# Install the Pendulum

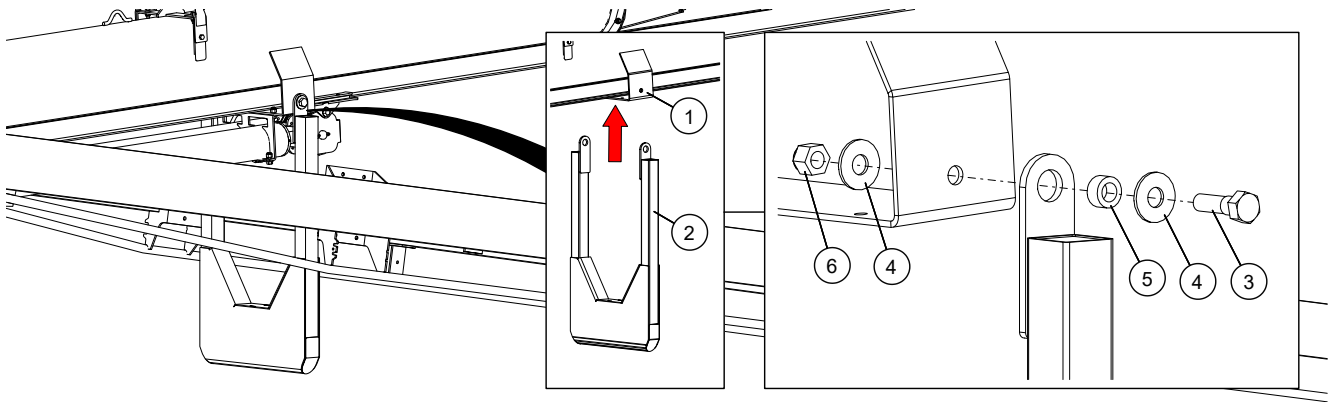

1	auger tube	4	plain washer, M20
2	auger lean pendulum	5	bushing
3	hex bolt, M20 x 65L	6	nylock nut, M20

# Install the Crossmember

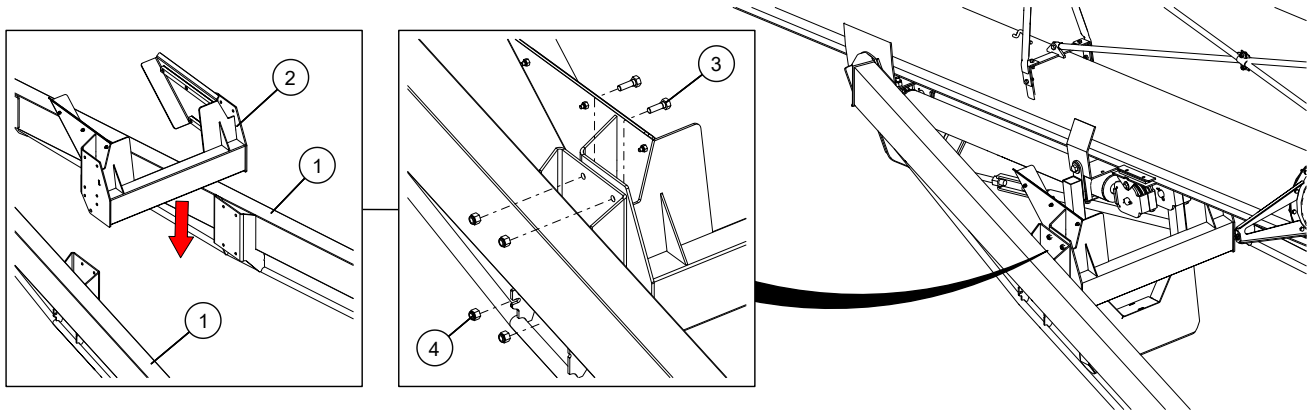

**Assembly Note:**

- Attach the auger lean crossmember to the lower reach arms using the existing hardware.

1	lower reach arm	3	hex bolt, M14 x 40L
2	auger lean crossmember	4	nylock nut, M14

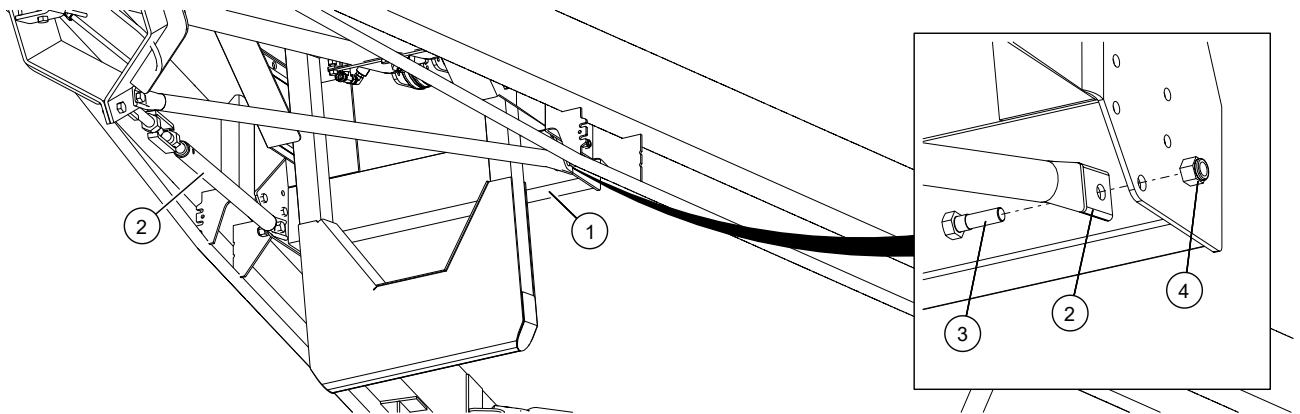

**Assembly Note:**

- Attach the stabilizer braces to the auger lean crossmember using the existing hardware.

1	auger lean crossmember	3	hex bolt, M16 x 50L
2	stabilizer brace	4	nylock nut, M16

# Pendulum Engaged/Disengaged Position

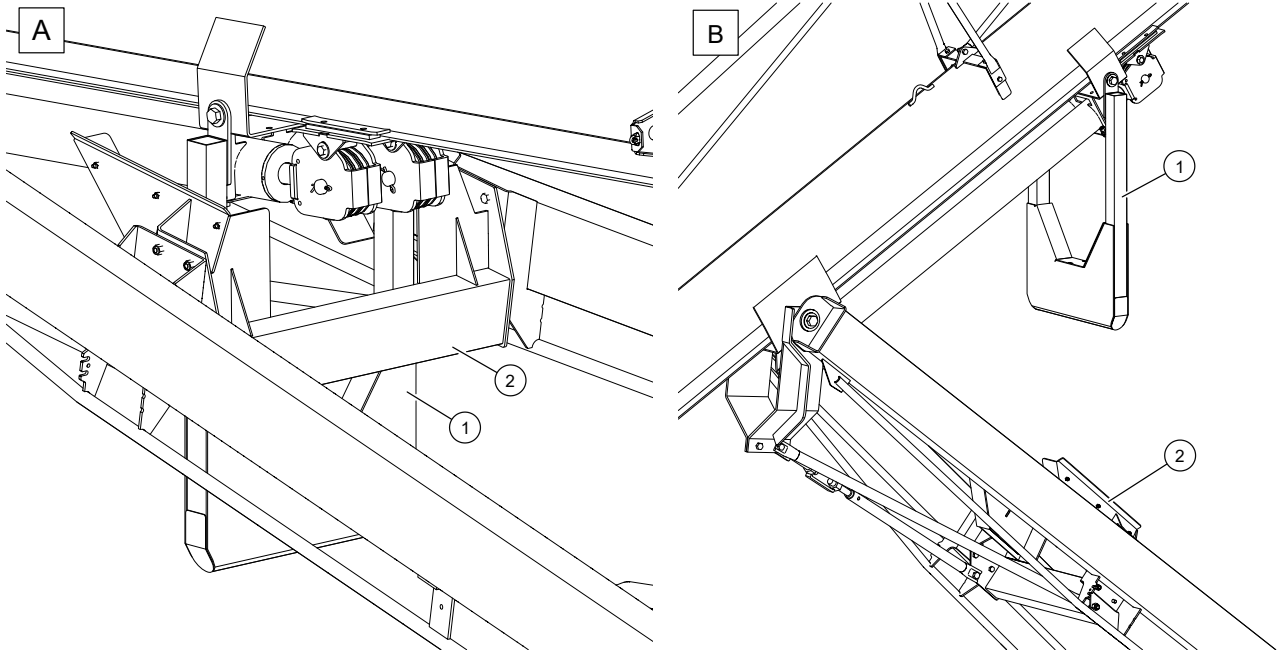

**Assembly Notes:**

- The pendulum must always be pointing towards the ground.
- Make sure the pendulum is in the engaged position when the auger is fully lowered.
- Make sure the pendulum is in the disengaged position when the auger is fully raised.

1	auger lean pendulum	A	engaged position
2	auger lean crossmember	B	disengaged position

Milltec is an AGI Brand.

AGI is a leading provider of equipment solutions for agriculture bulk commodities including seed, fertilizer, grain, and feed systems with a growing platform in providing equipment and solutions for food processing facilities. AGI has manufacturing facilities in Canada, the United States, the United Kingdom, Brazil, South Africa, India and Italy and distributes its products globally.

**AGI MILLTEC**

51-A, 1<sup>st</sup> Phase, KIADB Industrial Area, Bommasandra Bangalore-560099, India  
 P +91.80.27831128 | F +91.80.27831129 | E milltec@milltecmachinery.com

AGGROWTH.COM aggrowthintl   
 ©Ag Growth International Inc. 2025 | Printed in India